



WRIGHT STATE UNIVERSITY | LAKE CAMPUS

**Program and Schedule of Sessions
Friday, April 10, 2026**

Friday Night Reception and Ignite Talks: Celina Eagles Lodge

5:30 - 7:30 PM	Join us for appetizers, drinks, and Ignite Talks at the Celina Eagles Lodge
5:45 PM	Welcome: Joe Cavanaugh, Professor, Economics, WSU Lake and AURCO Board Member Diane Huelskamp, Associate Professor, Science Education, WSU Lake
6:00 PM	Ignite Talks: <ol style="list-style-type: none"> 1. Burnout and Psychological Distress Among Regional Campus Faculty in Ohio; <i>Dr. Elliott Jardin, Madison Roberts, Taylor Whitton, Miami Middletown; Daisy Park, Miami Hamilton</i> 2. Promoting STEAM via AR development with Lens Studio and Snapchat; <i>Tasha Penwell, Bytes and Bits</i> 3. Utilizing Campus Environments to Induce Awe; <i>Dr. Josh Ricker, Wright State Lake</i>

Saturday, April 11, 2026

Conference: Wright State University - Lake Campus

8:00 - 9:45 AM	Breakfast & Check-in	Dicke Hall
9:00 - 9:45 AM	Welcome & Keynote Speaker Rooted and Rising: How Regional Campuses Change Lives; <i>Dr. Andrea Faber, Vice Provost, Chief Administrative Officer, Wright State University Lake Campus</i>	Dicke Hall
10:00 AM - 1:00 PM*	Concurrent Sessions <i>*11:00 AM - 12:00 PM Student Poster Competition Presentations and Judging</i>	Various Classrooms
1:00 - 2:00 PM	Lunch, Student Awards, Concluding Remarks	Dicke Hall
2:00 - 4:00 PM	AURCO Business Meeting - Representatives from all campuses are welcome	Dicke Hall

Session 1 (10:00 - 10:55 AM)

Location	Title 1 (10:00-10:25 AM)	Title 2 (10:30-10:55 AM)
DH 150	The “Capital Gap” and Higher Education; <i>Dr. Giovanna Follo, Wright State University - Lake Campus</i>	College Preparedness and Postsecondary Progression Among First-Generation College Students: A Literature Review; <i>Dr. Bernard Caldwell, Miami Hamilton</i>
DH 152	Integrating Open Educational Resources (OER) with AI tools - Teaching Mathematics; <i>Dr. Weiqun Zhang, Wright State Lake</i>	
DH 154	The Coming-of-Age Motif in the Western: Some Ohio Writers; <i>Matt Wanat, OU Lancaster</i>	Shakespeare in the Blended CCP/Regional Campus Classroom: A Miami University Regionals (MUR) Case Study; <i>Dr. Katherine Kickel, Miami Hamilton</i>
DH 177	Leveraging Self-Graded Assignments to Engage Students and Build Self-Efficacy; <i>Stacey Benton, UC Blue Ash</i>	How to "Excel" at Making Review Activities Fun with Commonly Available Software; <i>Dr. Thomas Stringfield, UC Blue Ash</i>
DH 226	<u>50-minute presentation:</u> Intentional Mentoring in Action: A Guided Planning Workshop; <i>Dr. Cathy Bishop-Clark, Miami Hamilton</i>	
DH 229	<u>50-minute presentation:</u> The Assessment Dead Zone: A Candid Discussion of Learning in the AI Era; <i>Dr. Taylor Waiden, UC Blue Ash</i>	

Session 2 (11:00-11:55 AM)

Location	Title 1 (11:00-11:25 AM)	Title 2 (11:30-11:55 AM)
DH 150	An Assessment of Student Confidence in Knowledge of 20th and 21st Century Historical Subjects; <i>Dr. Thomas Bouril, Miami Middletown</i>	How to Unhide an Empire: Exploring Transnational Sonic Circuitries in the Classroom; <i>Dr. William Graci-Medina, UC Blue Ash</i>
DH 152	AURCO Benefits Rundown; <i>Dr. Joe Cavanaugh, Dr. Diane Huelskamp, Wright State Lake</i>	Analyzing the Public Discourse of Unions in Ohio Today to Understand the Importance of Unions: A Case Study of the University of Cincinnati Blue Ash College; <i>Dr. Neely Mclaughlin, UC Blue Ash</i>

DH 154	Cross-Departmental Collaboration to Raise Student Awareness of Successful Study Habits in Content Heavy Science Courses; <i>Dr. Amy Miller, Stacey Benton, Zachary Zalewski, UC Blue Ash</i>	Hardy-Weinberg Law: A Mathematical Application to Population Genetics; <i>Brent Fox, BGSU Firelands</i>
DH 177	Teaching to code 'Functions'; <i>Dr. Adity Mutsuddi, UC Blue Ash</i>	Tribute to Students and Instructors; <i>Dr. Jack Vazzana, KSU East Liverpool</i>
DH 226	<u>50-minute presentation:</u> Beyond Walls: Enhancing Student Learning Through Real-World Community Engagement; <i>Gail Maue, UC Blue Ash; Kimberly Clifford, UC Clermont</i>	
DH 229	<u>50-minute presentation:</u> Building Career and Life Skills Through Economics at a Regional Campus; <i>Nahreen Rahman, Dr. Rodney Swope, UC Blue Ash</i>	

Session 3 (12:00 -12:55 PM)

Location	Title 1 (12:00-12:25 PM)	Title 2 (12:30-12:55 PM)
DH 150	Navigating the messy middle: a journey of supporting faculty through Sensemaking; <i>Dr. Eric Steven Taylor, KSU Stark</i>	An Inquiry of Identity: How Rural Regional Students Make Meaning of a Cultural Immersion at the Pine Ridge Reservation; <i>Kristine Harrington, KSU Salem</i>
DH 154	Health Status and Resource Awareness of College Students at a Regional Campus; <i>Kelsi Becker, Shawna Staud, UC Blue Ash</i>	Emotion Regulation and Academic Achievement: Evaluating the ERT Model in Varied Examination Contexts; <i>Dr. Daisy Park, Devika Khatiwada, Miami Hamilton</i>
DH 177	Enhancing Engagement and Mathematical Thinking in Online Courses: A Case Study for PMIQ Activity; <i>Adam Chekour, UC Blue Ash</i>	Evaluation of Workforce Skills; <i>Dr. Greg Homan, Wright State Lake</i>
DH 229	<u>50-minute presentation:</u> Developing Proficiency in Student Work: How to Implement Specifications Grading in Your Classroom; <i>Dr. Matthew DeMatteo, Smita Jadhav, UC Blue Ash</i>	

Student Posters

Exploring the Feasibility of Vibration Motors as Learning Aids for Individuals with Visual Impairments in Electric Circuit Experiments; *Nicholas Carter, UC Blue Ash*

Shattering stereotypes: A guide to teaching about ageism and promoting age diversity; *Lorena Cravens, Camilla Ellis, Elliot Jardin, Miami Middletown*

The Psychological Impact of Awe-Inducing Environments; *Joelle Delisle, Wright State Lake*

Knowledge is Power(less): The Failure of Information to Mitigate the Better than Average Effect; *Lily Juarez, UC Blue Ash*

Shockingly Superior: The Moral Humility Paradox in an Imagined Milgram Scenario; *Ethan Marsh, UC Blue Ash*

Learning How to Learn: Evaluating an Evidence-Based Metacognitive Video Series; *Madison Roberts, Taylor Whitton, Elliot Jardin, Miami Middletown*

A Solution Without a Problem: Examining the Impact of Ohio's SBI Mandates on Student Evaluations; *Jadyn Sano, Grace Cooksey, UC Blue Ash*

Idealizing the Self vs Humanizing Others: Role of Self-Esteem and Contingencies of Self-Worth in Predicting Moral Superiority; *Seth Steele, UC Blue Ash*

Global Classrooms: The Benefits of Studying Abroad; *Ella Wilson, Caitlyn Nuding, Melanie Marshall, Dave Hochstein Wright State Lake*

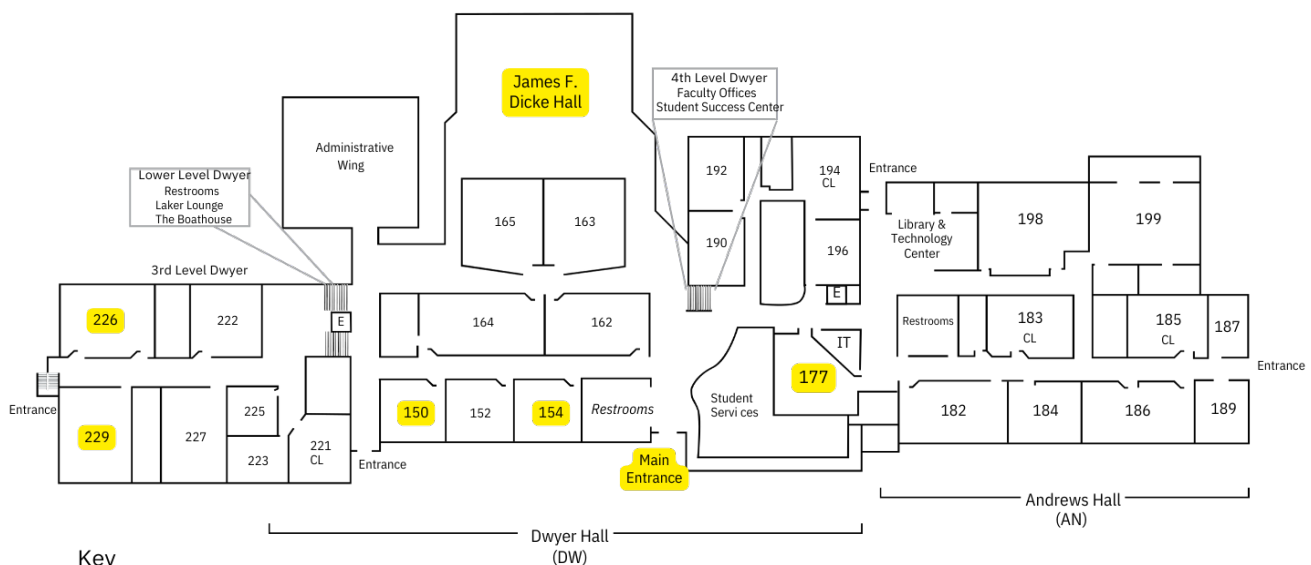

Key
 CL: ComputerLab
 E: Elevator
 IT: InformationTechnology
 Student Services: Academic Advising, Community Coordinator/Athletic Director, Counseling, Enrollment Services, Office of Disability Services

